

# 1251-1253 LEXINGTON AVENUE



**WINICK** RETAIL  
SPECIALISTS

PARK AVENUE

LEXINGTON AVENUE

THIRD AVENUE

EAST 88TH STREET



EAST 87TH STREET



EAST 86TH STREET

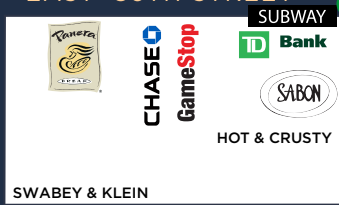

SWABEY & KLEIN

EAST 85TH STREET



EAST 84TH STREET



EAST 83TH STREET



EAST 82TH STREET

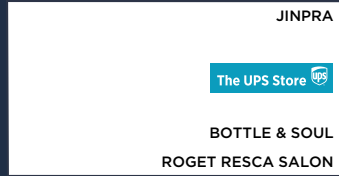

EAST 81TH STREET

EAST 88TH STREET



EAST 87TH STREET



EAST 86TH STREET

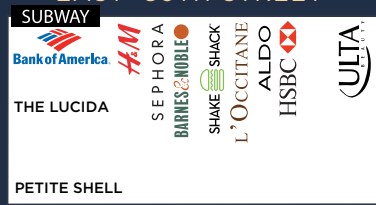

PETITE SHELL

EAST 85TH STREET



EAST 84TH STREET



EAST 83TH STREET



EAST 82TH STREET



EAST 81TH STREET

# 1251-1253 LEXINGTON AVENUE

Ground Floor  
4,147 SF

Lower Level  
3,000 SF

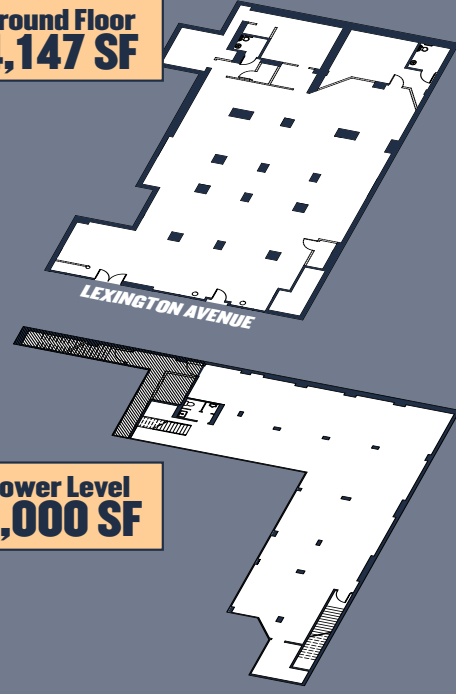

## ADDRESS

1251-1253 Lexington Avenue  
New York, NY 10028  
Between East 84th & East 85th Streets

## SIZE

Ground Floor: 4,147 SF  
Lower Level: 3,000 SF  
\*Divisions Considered

## CEILING HEIGHT

Ground Floor 17'  
Lower Level 13'

## ASKING PRICE

Upon Request

## POSSESSION

Immediate

## FRONTAGE

55' on Lexington Avenue

## COMMENTS

- Prime Upper East Side Restaurant/Retail Opportunity.
- Previously Operating as "Jack Rabbit & Radio Shack".
- Selling Lower Level.
- All uses considered.
- New direct long term lease.

## NEIGHBORS

Starbucks, CVS Pharmacy, Duane Reade, H&M, Best Buy, Sephora, Shake Shack, Dunkin Donuts, Sweetgreen, Pressed Juicery

FOR MORE INFORMATION CONTACT EXCLUSIVE AGENTS:

**JOSHUA SIEGELMAN**

212.792.2613

jsiegelman@winick.com

**MICHAEL SHKRELI**

212.792.2638

mshkreli@winick.com

**WINICK** RETAIL SPECIALISTS

WINICK REALTY GROUP LLC  
LICENSED REAL ESTATE BROKERS  
655 Third Avenue, 8th Floor, New York, NY 10017  
T. 212.792.2600 F. 212.792.2660 winick.com

Although all information regarding property for sale, rental or financing is from sources deemed reliable such information has not been verified, and no express representation is made nor is any to be implied as to the accuracy thereof, and it is submitted subject to errors, omissions, change of price, rental or other conditions, prior sale, lease or financing, or withdrawal without notice.