

**WINICK** RETAIL  
SPECIALISTS

# 27-21 44<sup>TH</sup> DRIVE

LONG ISLAND CITY  
BETWEEN JACKSON AND THOMSON AVENUES  
LONG ISLAND CITY, NY 11101





# 27-21 44<sup>TH</sup> DRIVE

## SIZE

Ground Floor 5,850 SF - Approx. 13' Ceilings

## FRONTAGE

69' on 44<sup>th</sup> Drive

## POSSESSION

Summer 2017

## HIGHLIGHTS

New construction, with 120 condo units

Steps from Court Square

Food will be considered, no cooking

**7 G E M** Subways nearby

## NEIGHBORS

Chipotle Mexican Grill, Bright Horizons, Citibank Building, Food Cellar, Sweetleaf, Queens Library, Nespresso, Subway, Dunkin' Donuts, CUNY School of Law, Learning Experience and many more...

**WINICK** RETAIL  
SPECIALISTS

Winick Realty Group LLC, Licensed Real Estate Brokers  
655 Third Avenue, 8th Floor | New York, NY 10017  
T 212.792.2600 | F 212.792.2660 | winick.com

ALTHOUGH ALL INFORMATION REGARDING PROPERTY FOR SALE, RENTAL OR FINANCING IS FROM SOURCES DEEMED RELIABLE SUCH INFORMATION HAS NOT BEEN VERIFIED, AND NO EXPRESS REPRESENTATION IS MADE NOR IS ANY TO BE IMPLIED AS TO THE ACCURACY THEREOF, AND IT IS SUBMITTED SUBJECT TO ERRORS, OMISSIONS, CHANGE OF PRICE, RENTAL OR OTHER CONDITIONS, PRIOR SALE, LEASE, OR FINANCING, OR WITHDRAWAL WITHOUT NOTICE.

Ground

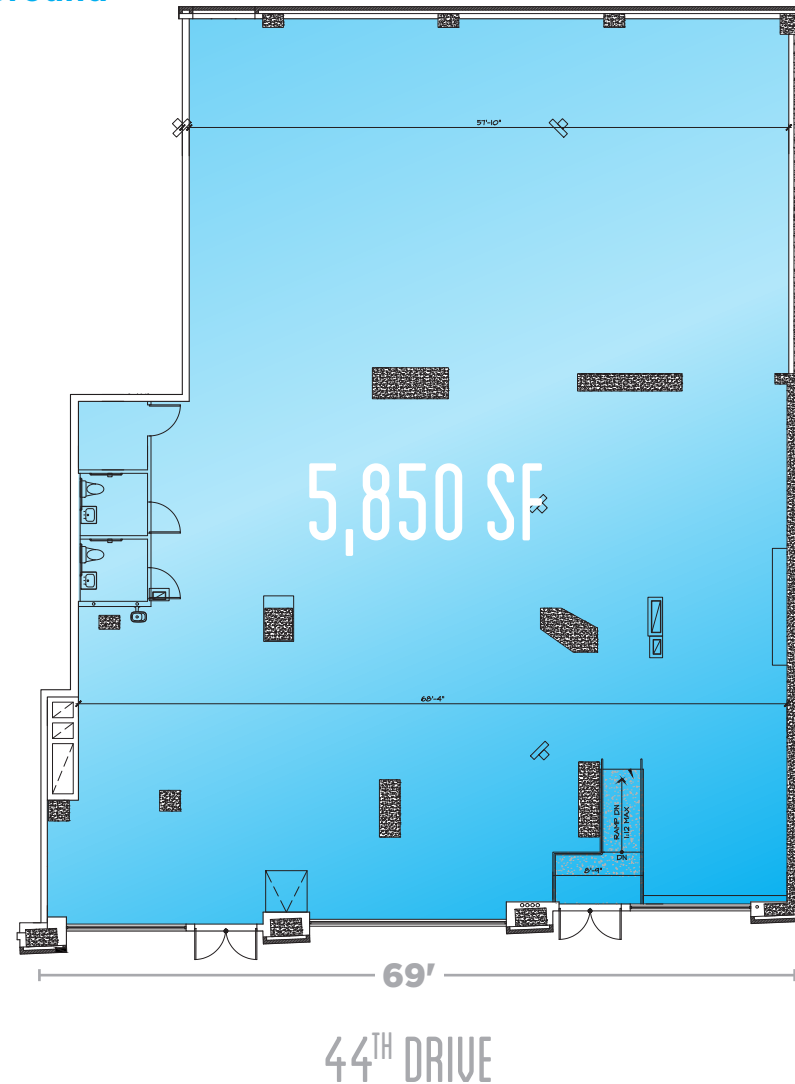

For more information, please  
contact our exclusive agent:

**Hal Shapiro**  
212.792.2623  
hal@winick.com

**Jeff Winick, CEO**  
212.792.2601  
jeff@winick.com