

# 80 Maiden Lane

Between Pearl and William Streets  
New York, NY 10038



*As Exclusive Agents, we are pleased to offer the following retail opportunity:*

- SIZE:** 3,000-4,000 SF – 18 foot ceilings – Several Divisions Considered  
\*More space can be made available
- POSSESSION:** Arranged
- ASKING RENT:** Upon Request
- FRONTAGE:** 15 or 30 Feet on Maiden Lane
- COMMENTS:**
- All Uses Considered – Long Term Direct Deal Possible!
  - Prime retail location in the heart of Financial District
  - Located among the highest grossing locations for many food tenants
- NEIGHBORS:** Chipotle, Pret a Manger, Just Salad, Subway, Hale & Hearty Soups, Chop't, Pump Energy Food, Goodburger, Potbelly, Starbucks

**FOR FURTHER INFORMATION PLEASE CONTACT:**

**Lee Block**  
212-792-2649  
[lee@winick.com](mailto:lee@winick.com)

**Elie Dayan**  
212-792-2621  
[edayan@winick.com](mailto:edayan@winick.com)

**Winick Realty Group LLC - Licensed Real Estate Brokers**

655 Third Avenue, 8th Floor, New York, NY 10017 T: 212-792-2600 F: 212-792-2660 [www.winick.com](http://www.winick.com)

ALTHOUGH ALL INFORMATION REGARDING PROPERTY FOR SALE, RENTAL OR FINANCING IS FROM SOURCES DEEMED RELIABLE SUCH INFORMATION HAS NOT BEEN VERIFIED, AND NO EXPRESS REPRESENTATION IS MADE NOR IS ANY TO BE IMPLIED AS TO THE ACCURACY THEREOF, AND IT IS SUBMITTED SUBJECT TO ERRORS, OMISSIONS, CHANGE OF PRICE, RENTAL OR OTHER CONDITIONS, PRIOR SALE, LEASE OR FINANCING, OR WITHDRAWAL WITHOUT NOTICE.

**RETAIL**

# 80 Maiden Lane

Between Pearl and William Streets  
 New York, NY 10038

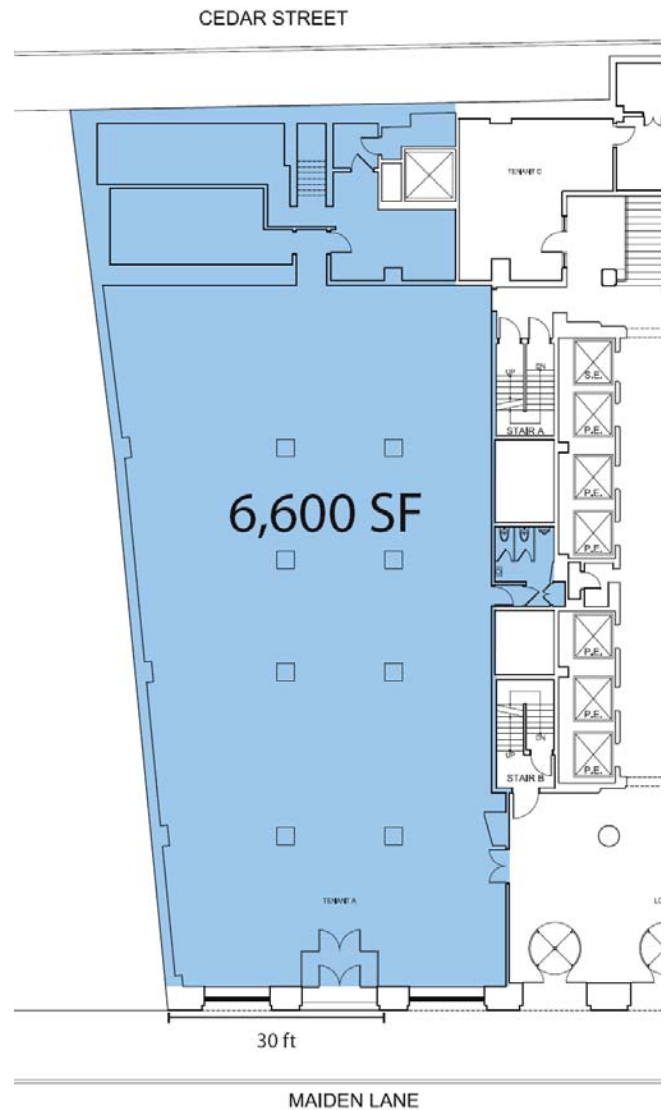

3,000-4,000 SF Available  
 Several Divisions Considered

**Winick Realty Group LLC - Licensed Real Estate Brokers**

655 Third Avenue, 8th Floor, New York, NY 10017 T: 212-792-2660 F: 212-792-2660 www.winick.com

ALTHOUGH ALL INFORMATION REGARDING PROPERTY FOR SALE, RENTAL OR FINANCING IS FROM SOURCES DEEMED RELIABLE SUCH INFORMATION HAS NOT BEEN VERIFIED, AND NO EXPRESS REPRESENTATION IS MADE NOR IS ANY TO BE IMPLIED AS TO THE ACCURACY THEREOF, AND IT IS SUBMITTED SUBJECT TO ERRORS, OMISSIONS, CHANGE OF PRICE, RENTAL OR OTHER CONDITIONS, PRIOR SALE, LEASE OR FINANCING, OR WITHDRAWAL WITHOUT NOTICE.