

175 KENT AVENUE

Corner of North Third Street
Brooklyn, NY 11211



As exclusive agents, we are pleased to offer the following retail opportunity:

- SIZE:** Ground Floor: 5,235 Square Feet (**Corner**)
Lower Level: 18,228 Square Feet
*****RETAIL CORNER with ESCALATORS*****
- ASKING RENTS:** Upon Request
- POSSESSION:** Immediate
- FRONTAGE:** 88 Feet on Kent Avenue
55 Feet on North 3rd Street
- COMMENTS:**
- **EXCELLENT CORNER LOCATION**
 - New Construction
 - Covered Parking Garage (**2 Levels**)
 - Loading Dock
 - Minutes from Manhattan
 - Residential Development over 6,000 new apartments
- NEIGHBORS:** Brooklyn Industries, American Apparel, Sea Restaurant, Planet Thai, CVS, Duane Reade, HSBC, Blue Bottle Coffee, Bedford Cheese Shop, Brooklyn Brewery, Fiore, Relish, Nita Nita Restaurant, Zebulon Bar/Café, Subway

FOR FURTHER INFORMATION PLEASE CONTACT:

Diana D. Boutross
(212) 792-2608
diana@winick.com

Lori Shabtai, EVP
(212) 792-2641
lori@winick.com

Jeff Winick, CEO
(212) 792-2601
jeff@winick.com

RETAIL

Winick Realty Group LLC - Licensed Real Estate Brokers

655 Third Avenue, 8th Floor, New York, NY 10017 T: 212-792-2600 F: 212-792-2660 www.winick.com

ALTHOUGH ALL INFORMATION REGARDING PROPERTY FOR SALE, RENTAL OR FINANCING IS FROM SOURCES DEEMED RELIABLE SUCH INFORMATION HAS NOT BEEN VERIFIED, AND NO EXPRESS REPRESENTATION IS MADE NOR IS ANY TO BE IMPLIED AS TO THE ACCURACY THEREOF, AND IT IS SUBMITTED SUBJECT TO ERRORS, OMISSIONS, CHANGE OF PRICE, RENTAL OR OTHER CONDITIONS, PRIOR SALE, LEASE OR FINANCING, OR WITHDRAWAL WITHOUT NOTICE.

GROUND FLOOR:

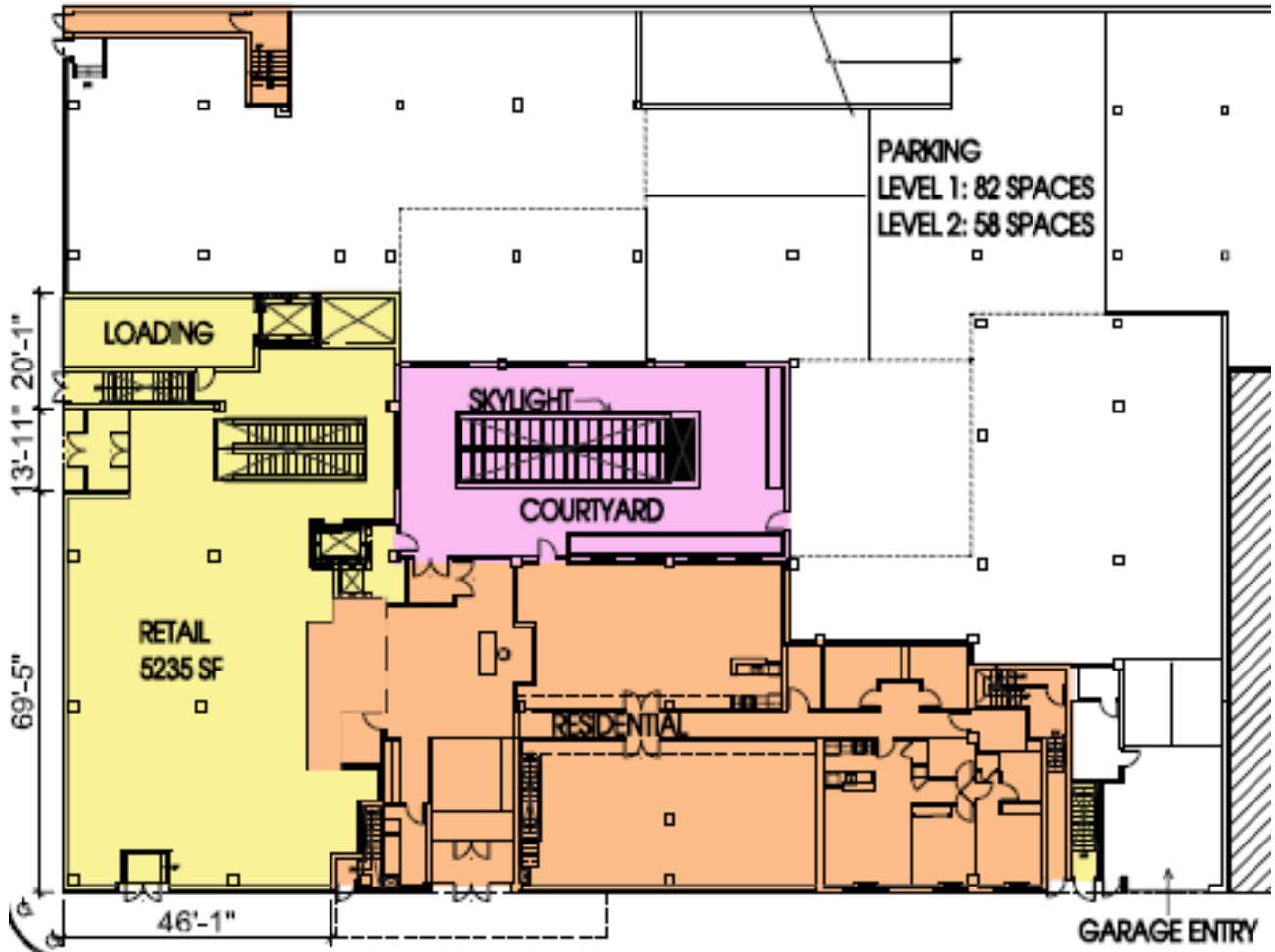

Winick Realty Group LLC - Licensed Real Estate Brokers

655 Third Avenue, 8th Floor, New York, NY 10017 T: 212-792-2600 F: 212-792-2660 www.winick.com

ALTHOUGH ALL INFORMATION REGARDING PROPERTY FOR SALE, RENTAL OR FINANCING IS FROM SOURCES DEEMED RELIABLE SUCH INFORMATION HAS NOT BEEN VERIFIED, AND NO EXPRESS REPRESENTATION IS MADE NOR IS ANY TO BE IMPLIED AS TO THE ACCURACY THEREOF, AND IT IS SUBMITTED SUBJECT TO ERRORS, OMISSIONS, CHANGE OF PRICE, RENTAL OR OTHER CONDITIONS, PRIOR SALE, LEASE OR FINANCING, OR WITHDRAWAL WITHOUT NOTICE.

LOWER LEVEL:

